

PARTS DIAGRAM

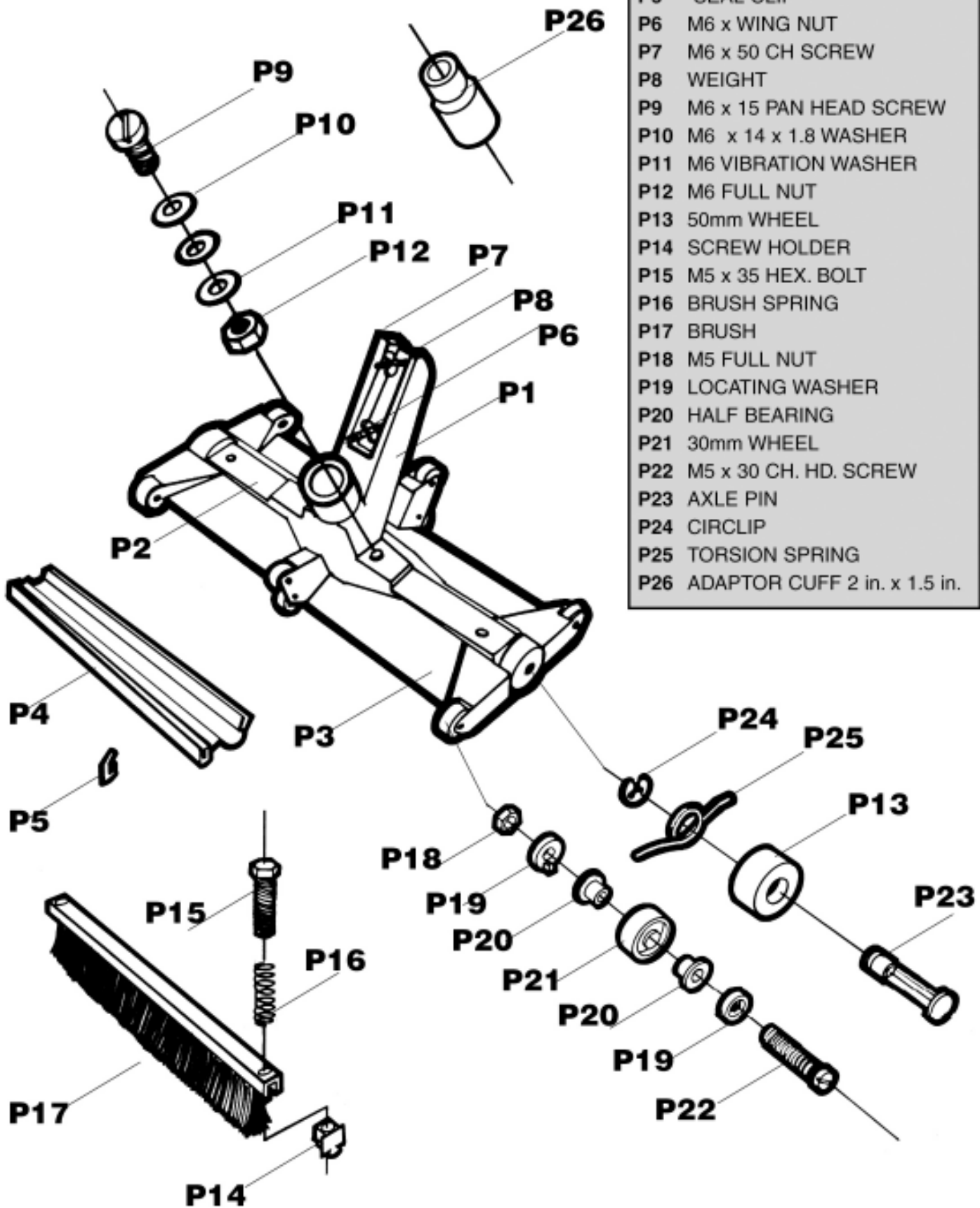

- P1 HANDLE
- P2 CENTRE BODY
- P3 FLAP
- P4 FLAP SEAL
- P5 SEAL CLIP
- P6 M6 x WING NUT
- P7 M6 x 50 CH SCREW
- P8 WEIGHT
- P9 M6 x 15 PAN HEAD SCREW
- P10 M6 x 14 x 1.8 WASHER
- P11 M6 VIBRATION WASHER
- P12 M6 FULL NUT
- P13 50mm WHEEL
- P14 SCREW HOLDER
- P15 M5 x 35 HEX. BOLT
- P16 BRUSH SPRING
- P17 BRUSH
- P18 M5 FULL NUT
- P19 LOCATING WASHER
- P20 HALF BEARING
- P21 30mm WHEEL
- P22 M5 x 30 CH. HD. SCREW
- P23 AXLE PIN
- P24 CIRCLIP
- P25 TORSION SPRING
- P26 ADAPTOR CUFF 2 in. x 1.5 in.